

# AIRobot V8



## As standard equipment, includes

- constant flow
- integrated CO<sub>2</sub>, VOC, air temperature, humidity and PM sensors
- autonomous control – smart control of fans ensures energy efficiency and good indoor air quality
- room occupancy sensing (together with energy saving mode)
- humidity detection mode.

## Specifications

<b>Installation</b>	wall-mounted or floor frame
<b>Airflow up to</b>	750 m <sup>3</sup> /h or 208 l/s or 350 m <sup>2</sup> ventilated area
<b>Heat exchanger</b>	HRV: plate heat exchanger with heat recovery ERV: plate heat exchanger with moisture and heat recovery is planned for the end of 2023
<b>Heat recovery efficiency (70% airflow)</b>	V8: 85,4%, V8 ERV: 80,5%
<b>Filters</b>	exhaust air ePM10 55% (M5) / outside air ePM1 55% (F7)
<b>Power supply</b>	1~230 VAC 50 Hz
<b>Maximum power</b>	3,6 kW
<b>Fans</b>	2×170 W RadiCal EC
<b>Preheater (frost protection)</b>	integrated, nominal power 2,7 kW PTC, 0–100% control
<b>Special power SPI (V8 / V8 ERV)</b>	0.25 / 0.25 W/(m <sup>3</sup> /h) <sup>525 m<sup>3</sup>/h / 50 Pa</sup>
<b>Special power SFP (V8 / V8 ERV)</b>	0.917 / 0.917 W/(m <sup>3</sup> /s) <sup>525 m<sup>3</sup>/h / 50 Pa</sup>
<b>Condensate connection (mm)</b>	32 mm
<b>Colours</b>	white, black
<b>Packaging</b>	60 × 103 × 97,5 cm, weight 90 kg

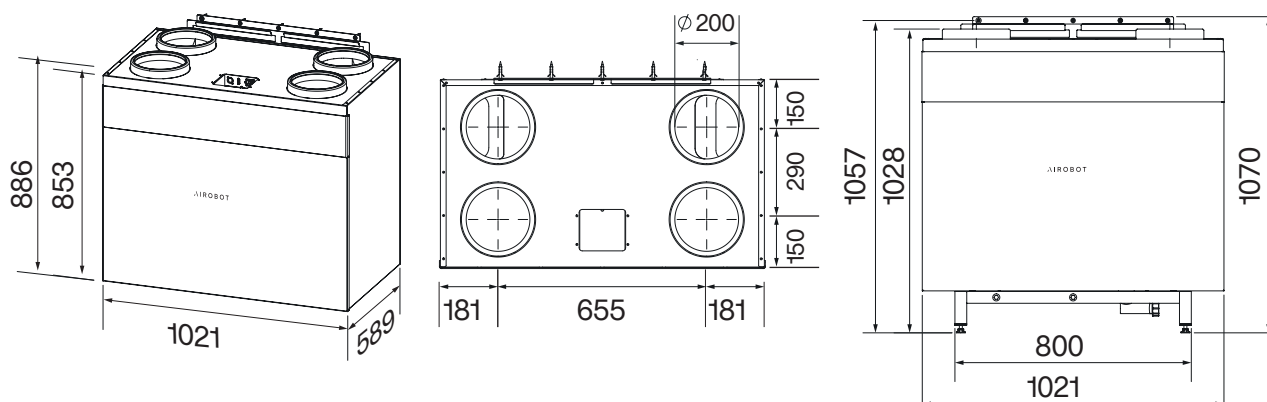

## Ducts

### TYPE R

1. Supply air
2. Extract air
3. Exhaust air
4. Outside air

### TYPE L

1. Exhaust air
2. Outside air
3. Supply air
4. Extract air

